

Route #60 BLUE ISLAND/26TH



Garage(s)/Run Numbers

Kedzie/K351-K390
 Block/K391-K400
 PTO/K401-K440

This is a *Night Owl* service network route. Be alert to possible changes in scheduled operation after midnight.

Terminals/Destination Signs

Eastbound	Westbound
Jackson/ Michigan	Cicero
Randolph Lakefront	Kedzie
	54th/Blue Line

Adams/Michigan
(not scheduled)

State/Washington

Kedzie
(pull-in)

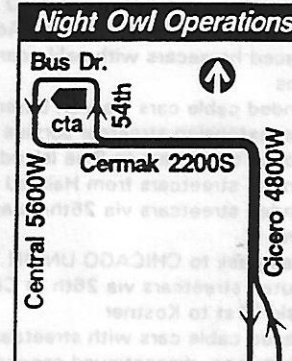
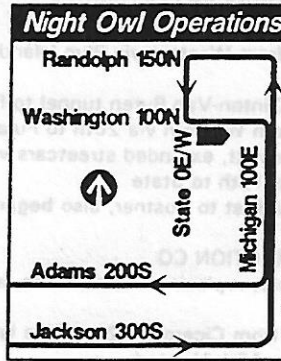

Schedule Interlocks

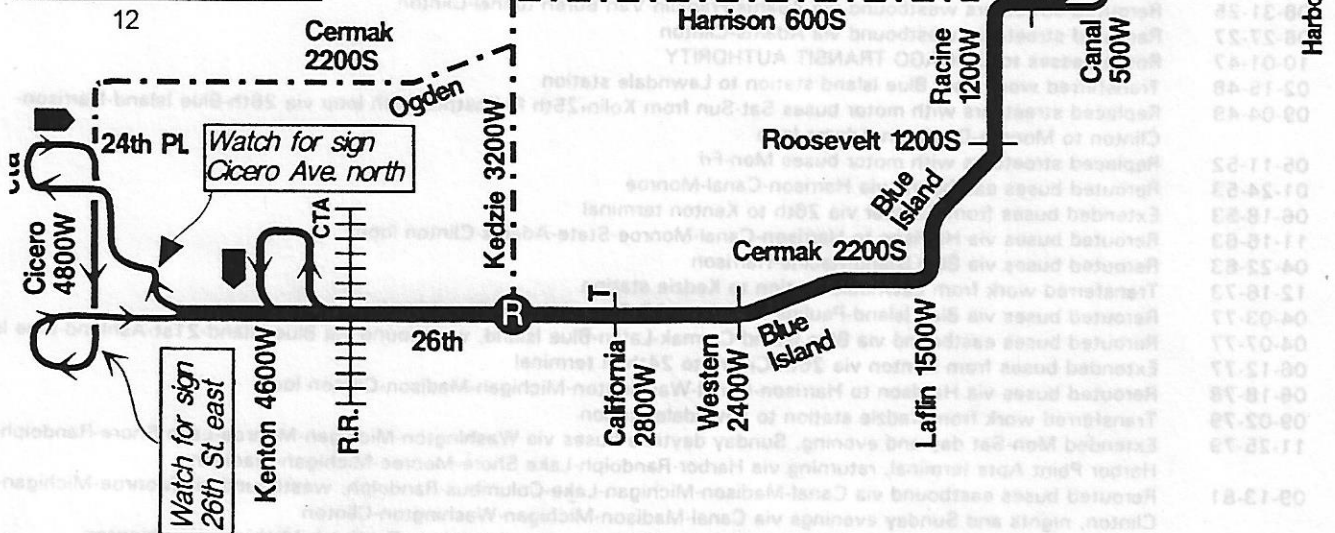

Hours of Operation

Terminals	Dir	Monday-Friday	Saturday	Sunday/holiday
Cicero/24th Place to Adams/Michigan	EB	24 hours	24 hours	24 hours
Adams/Michigan to Cicero/24th Place	WB			
Cicero/24th Place to Randolph/Harbor Drive	EB	0502-2305	0510-2305	0715-1903
Randolph/Harbor Drive to Cicero/24th Place	WB	0552-2352	0552-2352	0802-1955
Cermak/54th to Washington/State	WB	2317-0355	2317-0355	2321-0539

Shuttle Fares

Northwestern Station(Washington/Canal)	EB	0600-0930
LaSalle Station(Jackson/Financial Place)	"	"
Randolph Station(Michigan bet Lake & Randolph)	WB	"

BLUE ISLAND/26TH - route history

- 12-24-63 Began CHICAGO WEST DIVISION RY CO horsecar service from 13th Pl via Blue Island-Halsted-Madison to State
08- -69 Extended horsecars via Madison-State to Randolph
10-08-71 Cut back horsecars to Madison/State
- -72 Extended horsecars from 13th Pl via Blue Island to 15th
08- -75? Rerouted horsecars via Halsted-Van Buren to State
09-07-75 Rerouted horsecars via Halsted-Madison to State
08-22-76 Extended horsecars from 15th via Blue Island to 18th
- -77 Extended horsecars from 18th via Blue Island to Ashland
12- -79 Extended horsecars from Ashland via Blue Island to Western
07-30-88 Rerouted horsecars via Madison to Wells-Washington-State-Madison loop
03-15-89 Route passes to WEST CHICAGO STREET RR CO
- -90? Rerouted horsecars via Halsted-Adams-Clinton-Madison
07-27-93 Replaced horsecars with cable cars from Western via Blue Island-Halsted-Van Buren to Jefferson, then to downtown behind horses
04-22-94 Extended cable cars via Van Buren-Clinton-Van Buren tunnel to Franklin-Van Buren-Dearborn-Adams-Franklin loop
05-01-94 Began extension streetcar service from Western via 26th to Pulaski
- -96 Cut back cable cars to Blue Island/Leavitt, extended streetcars via 26th-Blue Island-Leavitt-18th to Halsted
10- -96 Extended streetcars from Halsted via 18th to State
12- -97 Extended streetcars via 26th-Pulaski-31st to Kostner, also began shuttle streetcar service from Pulaski via 26th to Cicero
07-01-99 Routes pass to CHICAGO UNION TRACTION CO
- -05 Rerouted streetcars via 26th to Cicero, replacing shuttle route, and began shuttle streetcar service from 26th via Pulaski-31st to Kostner
07-20-06 Replaced cable cars with streetcars from Cicero via 26th-Blue Island-Blue Island-Harrison to Harrison-Dearborn-Adams-Franklin loop, discontinued service to 18th/Halsted
- -07 Discontinued Pulaski/31st shuttle service
01-29-08 Route passes to CHICAGO RYS CO
12-28-10 Cut back streetcars to 26th/Kenton
- -11 Rerouted streetcars via Harrison-Clinton-Van Buren tunnel to Franklin-Van Buren-Dearborn-Adams-Franklin loop
06-26-11 Began thru-route streetcar service from Western via Blue Island-Harrison-Clinton-Adams-Wells-North to Clark
08-16-12 Extended thru-route streetcars from Western via 26th to Kenton
07- -13 Began shuttle streetcar service from Kenton via 26th to Cicero
02-01-14 Routes pass to CHICAGO SURFACE LINES
05-21-17 Discontinued shuttle streetcar service to 26th/Cicero
01-29-22 Rerouted streetcars via Van Buren tunnel-Franklin to Franklin-Monroe-Dearborn-Adams loop
09-14-24 Rerouted streetcars via Clinton to Clinton-Monroe-Dearborn-Adams loop
08-31-25 Rerouted streetcars westbound via Adams-Franklin-Van Buren tunnel-Clinton
08-27-27 Rerouted streetcars westbound via Adams-Clinton
10-01-47 Route passes to CHICAGO TRANSIT AUTHORITY
02-15-48 Transferred work from Blue Island station to Lawndale station
09-04-49 Replaced streetcars with motor buses Sat-Sun from Kolin-25th Pl-Kostner-26th loop via 26th-Blue Island-Harrison-Clinton to Monroe-Dearborn-Adams loop
05-11-52 Replaced streetcars with motor buses Mon-Fri
01-24-53 Rerouted buses eastbound via Harrison-Canal-Monroe
06-18-53 Extended buses from Kostner via 26th to Kenton terminal
11-16-63 Rerouted buses via Harrison to Harrison-Canal-Monroe-State-Adams-Clinton loop
04-22-63 Rerouted buses via Blue Island-Racine-Harrison
12-16-73 Transferred work from Lawndale station to Kedzie station
04-03-77 Rerouted buses via Blue Island-Paulina NB/Wood SB-Cermak-Lafkin-Blue Island
04-07-77 Rerouted buses eastbound via Blue Island-Cermak-Lafkin-Blue Island, westbound via Blue Island-21st-Ashland-Blue Island
06-12-77 Extended buses from Kenton via 26th-Cicero to 24th Pl terminal
06-18-78 Rerouted buses via Harrison to Harrison-Canal-Washington-Michigan-Madison-Clinton loop
09-02-79 Transferred work from Kedzie station to Lawndale station
11-25-79 Extended Mon-Sat day and evening, Sunday daytime buses via Washington-Michigan-Monroe-Lake Shore-Randolph-Harbor to Harbor Point Apts terminal, returning via Harbor-Randolph-Lake Shore-Monroe-Michigan-Madison
09-13-81 Rerouted buses eastbound via Canal-Madison-Michigan-Lake-Columbus-Randolph, westbound via Monroe-Michigan-Washington-Clinton, nights and Sunday evenings via Canal-Madison-Michigan-Washington-Clinton
11-25-81 Rerouted buses eastbound via Madison-Michigan-Randolph, westbound via Randolph-Michigan-Washington
07-01-84 Transferred work from Lawndale station to Kedzie station
09-08-85 Rerouted buses eastbound via Canal-Adams-Michigan, westbound via Michigan-Jackson-Clinton, nights and Sunday evenings via Canal-Adams-Michigan-Jackson-Clinton
04-20-86 Rerouted buses eastbound via Canal-Jackson-Michigan, westbound via Michigan-Adams-Clinton
09-07-86 Transferred work from Kedzie station to Lawndale station
07-03-94 Transferred work from Lawndale garage to Kedzie garage
09-11-94 Began Night Owl Service adding "N" prefix to route number during owl period and extended buses via Michigan-Randolph-State-Washington-Michigan with the layover location at State/Washington
09-10-95 Rerouted buses westbound Blue Island-Lafkin-Cermak-Blue Island
04-26-98 Extended Night Owl service to 54th/Blue Line Terminal