

Route #80W - WEST IRVING PARK (Local and Express)

80W

Garage(s)/Run Numbers

Forest Glen/F241-F260

Terminals/Destination Signs

<u>Eastbound</u>	<u>Westbound</u>
------------------	------------------

Neenah (local)	*Cumberland
*Irving Park WNW station	*River Rd. station
	Harlem (local) (unscheduled)

*Both local and express signs

Schedule Interlocks

#56
#78
#85
#85A

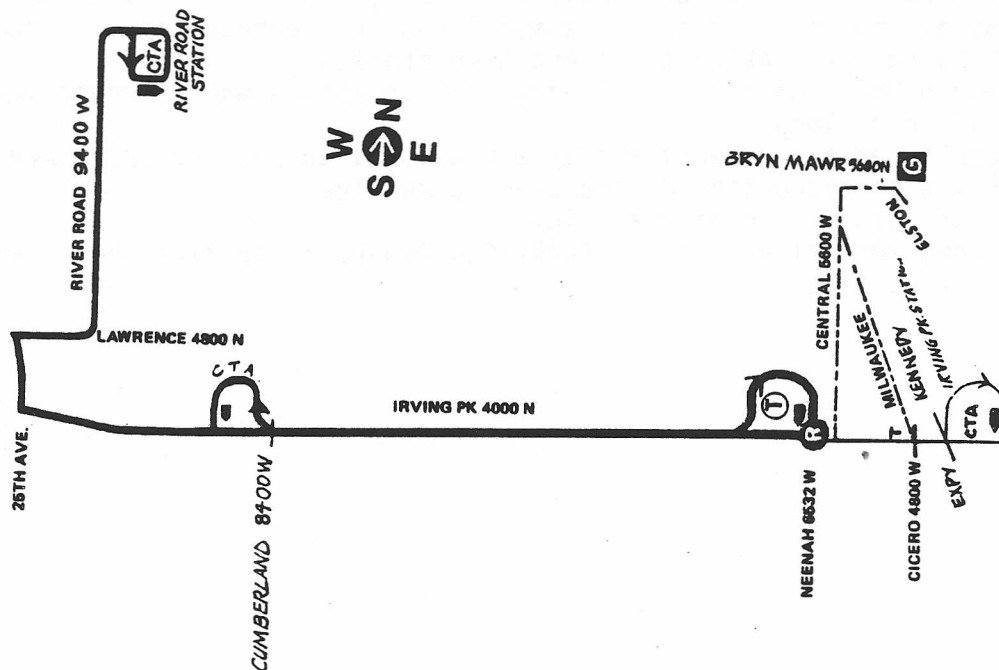

Hours of Operation

Service between Neenah and Cumberland - Mon-Sat day and early evening hours,
Sun/Hol noon thru early evening hours

Service extended west to River Road station Mon-Fri AM thru PM rush hours

Express service extended east to Irving Pk/Pulaski station Mon-Fri AM & PM rush

Express stops east of Narragansett: Austin, Central, Cicero, Irving Pk WNW sta.

01/27/85

WEST IRVING PARK - route history

- 10-03-28 Inaugurated CMC bus service from Fillmore-Mason-Roosevelt loop via Austin-North-Narragansett-Irving Park to Neva-Byron-Harlem loop
- 03-08-30 Discontinued CMC bus service
- 07-06-30 Inaugurated CSL extension bus service from Neenah "Y" via Irving Park to Neva "Y"
- 07-26-31 Extended buses via Irving Park to Acacia Park Cemetery gate "U"
- 07-10-32 Extended buses via Irving Park to Pacific "Y"
- 01-27-43 Transferred work North Ave station to Lawrence station
- 02-04-47 Extended buses via Irving Park to Cumberland terminal
- 05-30-54 Thru-routed Irving Park buses with North/Narragansett buses, from Cumberland terminal via Irving Park-Narragansett-North to Harlem-Wabansia-Neva loop, operating SB through North/Narragansett terminal. Transferred former Irving Park work from Lawrence station to North Ave station
- 12-04-55 Transferred work North Ave station to Forest Glen station
- 07-09-58 Rerouted EB buses through Irving Park/Neenah terminal
- 08-03-59 Extended certain Mo-Fr rush trips via Irving Park-Cumberland to Montrose terminal, operating EB through Irving Park/Cumberland terminal
- 12-04-60 Transferred work Forest Glen station to North Ave station
- 01-24-64 Relocated Irving Park/Cumberland terminal 500' further west, account intersection realignment
- 07-13-64 Discontinued extension to Cumberland/Montrose
- 02-01-70 Disc'd thru-route, Irving Park buses operate from Cumberland terminal via Irving Park to Neenah terminal, weekday rush periods from Cumberland terminal via Irving Park to terminal east of Kennedy Expy. Transferred work North Ave station to Forest Glen station
- 04-07-75 Extended Mo-Sa daytime via Irving Park to 25th Avenue-Lawrence-River Rd-Old River Rd loop
- 09-13-81 Discontinued all Mon-Fri midday and all Sat to Lawrence/25th Ave (Shiller Park), also discontinued late evening service
- 01-03-82 Discontinued Sun morning service
- 02-27-83 Extended Mon-Fri via Irving Park-25th Ave-Lawrence-River Rd to River Rd station terminal