

At Forest Park Transit Center, transfer to Routes 17, 301, 303, 305, 308, 310, 317, 320, 737, 747, 757 and 767.

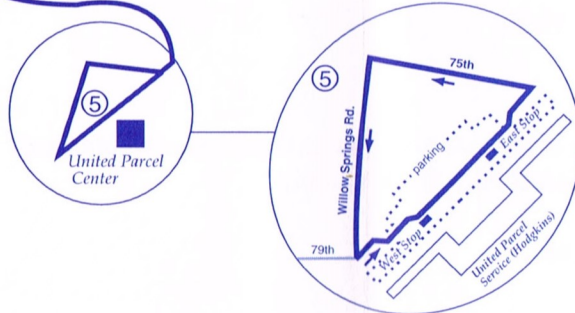

No local passengers may board/alight between Madison/Cicero and the Forest Park Transit Center.

Service operates express between the Forest Park Transit Center and UPS Hodgkins.



EXACT FARE REQUIRED
DRIVER HAS NO CHANGE

EXPRESS FARES	Adult	Reduced
Express Fares	1.35	.65
with Pace Commuter Club Card (CCC)	.20	.10
with Link-Up, PlusBus, or valid Pace Transfer	.20	.10
with Pace Ten-Ride Ticket	.20	.10

TRANSFERS	Adult	Reduced
Pace Transfers	.10	.05
Transfer to CTA (with cash)	.45	.25
with Commuter Club Card (CCC)	.65	.35
with CTA Token	.30	.15

PASSES/TICKETS	Adult	Reduced
Pace/CTA 30-Day Pass	75.00	35.00
Metra Link-Up	35.00	N/A
Pace Commuter Club Card (CCC)*	39.00	19.50
Metra PlusBus*	30.00	N/A
Pace Ten-Ride Plus Tickets*	11.50	5.50

*Pace Ten-Ride Plus Tickets, PlusBus and Commuter Club Card not valid on CTA

FARE INFORMATION

Reduced fares include children ages 7-11, senior citizens and persons with disabilities (with RTA Reduced Fare Card-a Medicare card along with another source of identification with a photograph and a date of birth is acceptable to obtain the RTA reduced fare card. For further information, please contact RTA at (836-7000) and students (high school or younger with appropriate identification) to and from school only on school days, between 6:00 a.m. and 8:00 p.m. CTA/Pace Everyday Monthly Pass and Commuter Club Card not valid for students. When accompanied by an adult fare paying passenger, a maximum of two children can ride FREE under age 7.

INFORMATION CENTER

If you need transit information please call:
The RTA Travel Information Center, open daily from 5:00 a.m. to 1:00 a.m. **836-7000**
TDD# (For HEARING IMPAIRED ONLY) **(312) 836-4949**
Pace Passenger Services, Monday through Friday from 8:00 a.m. to 5:00 p.m. **(847) 364-PACE (7223)**
TDD# (Pace information for HEARING IMPAIRED ONLY) **(847) 364-5093**

CARRIER INFORMATION

OPERATED BY: Pace West
For lost and found call (708)344-7400

ADDITIONAL INFORMATION

The schedules, fares and other information in this timetable are subject to change. Pace does not assume responsibility for errors in timetables, nor for inconvenience or damage resulting from delayed trains or buses or failure to make connections.

Bus will stop upon signal to driver at any intersection along the route where it is safe to do so except as noted.

<http://www.pacebus.com>



ROUTE 391 NEAR WEST SUBURBS TO UNITED PARCEL SERVICE

SERVICE TO HODGKINS

①	②	③	④	⑤
<u>MADISON CICERO</u>	<u>MADISON AUSTIN</u>	<u>MADISON HARLEM</u>	<u>FOREST PARK TRANSIT CENTER (SOUTH SIDE)</u>	<u>UPS HODGKINS</u>
2:40am	2:45am	2:51am	2:55am	3:20am
8:35	8:42	8:50	8:55	9:25
3:35pm	3:42pm	3:50pm	3:55pm	4:30pm
8:48	8:53	8:59	9:03	9:30

SERVICE TO NEAR WEST SUBURBS

⑤	④	③	②	①
<u>UPS HODGKINS</u>	<u>FOREST PARK TRANSIT CENTER (SOUTH SIDE)</u>	<u>MADISON HARLEM</u>	<u>MADISON AUSTIN</u>	<u>MADISON CICERO</u>
3:35am A	4:00am A	4:04am A	4:10am A	4:15am A
9:35	10:00	10:05	10:13	10:20
3:20pm	3:50pm	3:55pm	4:03pm	4:10pm
9:45	10:10	10:14	10:20	10:25

A- Trip operates Tuesday through Saturday.
Service operates for Monday through Friday shifts.

Due to constantly changing traffic conditions on the Tri-State, trips may run ahead of or behind schedule enroute to U.P.S. between Forest Park Transit Center & Hodgkins, and from U.P.S. between Forest Park Transit Center and Madison/Cicero.

Note: No local passengers may board/alight between Madison/Cicero and the Forest Park Transit Center.

No holiday service.