

TOUR OF

*Bus Overhaul
Shops*

SOUTH SHOPS

Open House

OCTOBER 1, 1963

CHICAGO TRANSIT
AUTHORITY



1. GENERAL OFFICE
2. MODEL RAPID TRANSIT EXHIBIT
3. MENS WASHROOM
4. MEDICAL BUS
5. BODY SHOP
5. A BODY REPAIR POSITIONS
5. B BODY REPAIR POSITIONS
5. C MACHINE SECTION
6. WELDING SHOP
7. BLACKSMITH SHOP
8. TIN SHOP
9. LOCKER ROOM
10. WASHROOM
11. DEGREASING ROOM
12. DOOR AND GLASS SHOP
13. UPHOLSTERY SHOP
14. WOOD WORK SHOP
15. LADIES WASHROOM
16. BODY SHOP
16. A BODY REPAIR POSITIONS
16. B MACHINE SECTION
16. C BODY REPAIR POSITIONS
17. PAINT SHOP
17. A PREPARATION
17. B TRIM AND FINISH
18. CHASSIS CLEANING ROOM
19. MENS WASHROOM
20. CHASSIS SHOP
20. A CHASSIS REPAIR POSITIONS
20. B CHASSIS REPAIR POSITIONS
21. BATTERY ROOM
22. OIL ROOM
23. REFRESHMENTS
24. LADIES WASHROOM
25. CHASSIS SHOP
26. EXHIBIT AREA

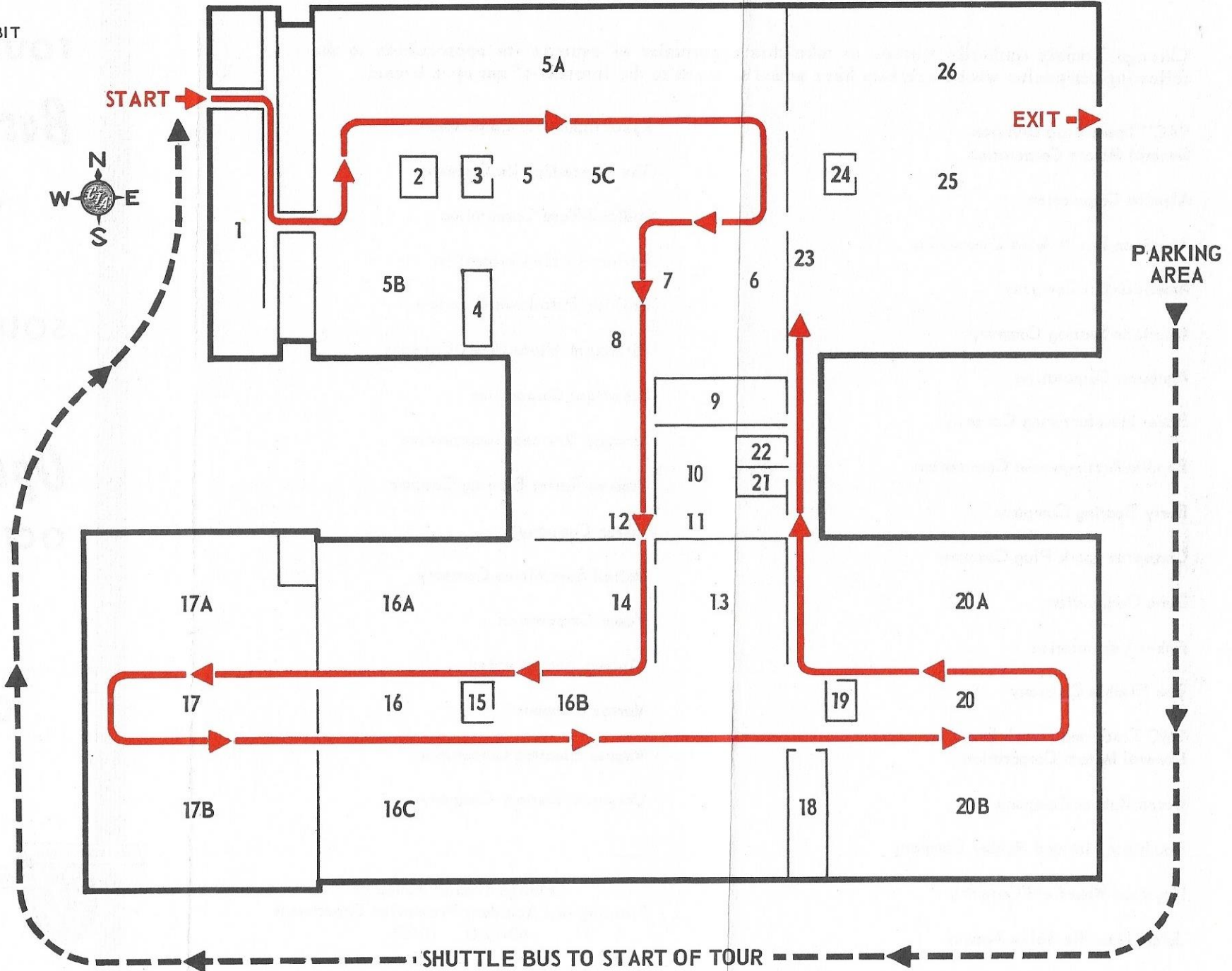

Chicago Transit Authority wishes to take this opportunity to express its appreciation to the following companies whose exhibits have added so much to the interest of our open house:

'AC' Spark Plug Division
General Motors Corporation

Alemite Corporation

American-Bosch-Arma Corporation

American Oil Company

American Seating Company

Armburst Corporation

Baker Manufacturing Company

Bendix-Westinghouse Corporation

Berry Bearing Company

Champion Spark Plug Company

Dana Corporation

Faber Laboratories

The Flexible Company

GMC Truck and Coach Division
General Motors Corporation

Gates Rubber Company

Goodyear Tire and Rubber Company

Heywood-Wakefield Company

Johns-Manville Sales Agency

Kysor Industrial Corporation

The Leece-Neville Company

Midland-Ross Corporation

Perfect Circle Corporation

Phillips Petroleum Company

Pittsburgh Plate Glass Company

Schwitzer Corporation

Sprague Devices, Incorporated

Timken Roller Bearing Company

Triton Company

United Specialties Company

Vapor Corporation

Vickers, Incorporated

Vortox Company

Wagner Electric Corporation

Universal Battery Company

Chicago Transit Authority
Training and Accident Prevention Department
63-12-0 10/63