

CTA ARTS IN TRANSIT PROGRAM



Artist: Christopher Tavares Silva



THE CHICAGO TRANSIT AUTHORITY
FRANK KRUESI, PRESIDENT
CAROLE L. BROWN, CHAIRMAN



CITY OF CHICAGO
RICHARD M. DALEY, MAYOR

DEPARTMENT OF CULTURAL AFFAIRS
LOIS WEISBERG, COMMISSIONER

GREGORY G. KNIGHT
DEPUTY COMMISSIONER/VISUAL ARTS



REQUEST FOR QUALIFICATIONS

CTA ARTS IN TRANSIT PROGRAM

The city of Chicago is home to one of the world's most expansive collections of public art. Since the unveiling of the Picasso sculpture at the Daley Civic Center Plaza in 1967, many significant works have been added to the collection. Additionally, parks, plazas, transit stations, municipal and private buildings throughout the city now include sculptures, murals, paintings, prints, stained glass and photographs by such renowned artists as Pablo Picasso, Louise Nevelson and Claes Oldenburg. More recently, the City of Chicago Public Art Program has commissioned works by local and national artists including Adam Brooks, Kerry James Marshall and Alison Saar. The new Millennium Park has also become a showcase of public art with works by Anish Kapoor, Jaume Plensa and Frank Gehry.

The public buildings and spaces of the city of Chicago provide evidence of a strong history of government support for the arts. Originally passed in 1978, the City of Chicago Percent-for-Art Ordinance further signifies the importance of artistic expression in Chicago.

In 2004, the Chicago Transit Authority (CTA) and the City of Chicago Public Art Program installed nine permanent works of art at eight rail stations on the Cermak Branch of the Blue Line. The CTA has since created an ongoing program to showcase permanent works of art in conjunction with the City of Chicago Public Art Program. The *Arts in Transit Program* is funded by the CTA, in partnership with the Federal Transit Administration, and will create opportunities to develop artwork for station reconstruction projects along the CTA Red and Brown Lines. Artists will be selected to create permanent artwork with input from the surrounding communities of each station.

The CTA and the City of Chicago Public Art Program, administered by the Department of Cultural Affairs, encourages and facilitates collaborations between artists, government agencies, the community and other partners. The City of Chicago Public Art Program is now seeking qualifications from local, national and international professional artists or artist teams capable of creating permanent public works of art for the CTA *Arts in Transit Program*. Artist teams must designate a primary contact for submissions to the Program.

THE SITES

Artwork will be installed at newly renovated rail stations in the city of Chicago. By combining the visibility and accessibility of the city's mass transit system with the creativity of Chicago's art resources, this program will result in a successful public display of professional works of art designed with input from nearby communities. The CTA *Arts in Transit Program* will provide high profile locations for public art and a new identity for the surrounding communities. In addition to fostering community pride, this program will provide CTA customers with visual stimulation and will beautify the city of Chicago as a whole.

Art opportunities are forthcoming at the following seven (7) CTA stations along the Red Line Dan Ryan Branch: Sox/35th, 47th, Garfield, 63rd, 69th, 79th, and 87th. Eighteen (18) stations will provide opportunities for art along the CTA Brown Line including Kimball, Kedzie, Francisco, Rockwell, Western, Damen, Montrose, Irving Park, Addison, Paulina, Southport, Belmont, Wellington, Diversey, Fullerton, Armitage, Sedgwick and Chicago. In addition, artwork will be incorporated in the reconstructed Howard station at the northern terminus of the Red Line. Some stations are currently under construction and all of these stations will be renovated by 2009. There will be various phases of art selection in accordance with CTA's renovation schedule. Artwork installation is planned to occur between October 2006 and 2009. Images of a number of the final station designs are available on the CTA website at www.transitchicago.com. Mediums under consideration include, but are not limited to, suspended (hanging) sculpture, mosaics, art glass, ornamental fencing, mixed-media artwork, and freestanding sculpture and furniture. The medium(s) appropriate for each station will be determined by the locations designated for art by the CTA.

TIMELINE

The deadline for completed Request for Qualifications (RFQ) for "Phase I" projects (Sox/35th, 47th, Garfield, 63rd, 69th, 79th, 87th, Kimball, Kedzie, Western, Francisco and Rockwell) of the *Arts in Transit Program* is **January 20, 2006**. The City of Chicago Public Art Program will accept submissions on a continual basis for subsequent phases until **January 20, 2007**. However, artists will qualify for a greater number of projects by complying with the January 20, 2006 deadline. Installation dates for artwork are dependent on the construction timeline of each affected station.

DEADLINE FOR RFQ FOR "PHASE I" PROJECTS: January 20, 2006

APPLICATION REVIEW: February through March 2006

ARTISTS SELECTED AS FINALISTS/RECEIPT OF RFP: April 2006

PROPOSALS DUE: June 2006

NOTIFICATION OF FINALISTS: July 2006

ARTWORK INSTALLED: October 2006 and ongoing

Artists' qualifications will be reviewed for subsequent project phases throughout 2006 and early 2007.

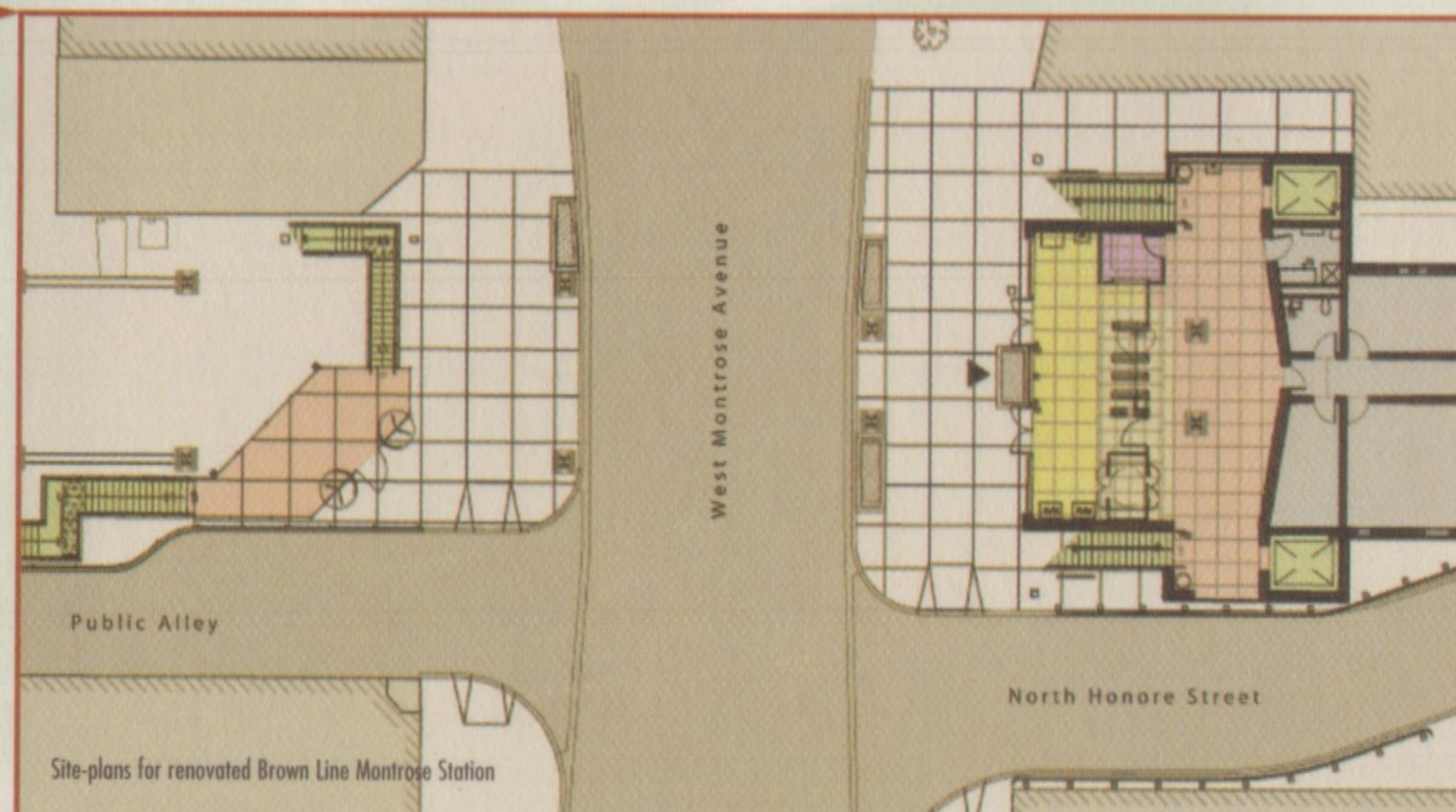

Site-plans for renovated Brown Line Montrose Station

ENTRY PROCESS

Submit a completed Slide Registry Form and addendum (attached) with:

- Up to 20 labeled slides or digital images (400-600 dpi, jpegs). If submitting digital images, a printed thumbnail index must be provided.
- A current resume*
- A written statement that articulates your qualifications and prior experience with comparable projects*
- Any support materials such as exhibition catalogs, reviews, artist's statements or magazine articles*

* Not to be submitted in digital format, printed copies only.

For inquiries or to request additional applications call: (312) 742-1161

Para más información, contacte a Fabi Ramirez de el Programa de Arte Publico al (312) 742-1156

Artists currently registered with the City of Chicago Public Art Program may use their current file for the CTA *Arts in Transit Program* by submitting only the completed Slide Registry Form and addendum (attached) to be added to their file. However, artists are encouraged to update their file with recent work reflective of their capabilities for the CTA *Arts in Transit Program*.

Only properly completed applications will be reviewed. Completed applications for "Phase I" are to be received at the Public Art Program office by **January 20, 2006**. All slides will be incorporated into the City of Chicago Public Art Program's Slide Registry and become the property of the City of Chicago. Send or deliver applications to:

CTA ARTS IN TRANSIT PROGRAM

PUBLIC ART PROGRAM

CITY OF CHICAGO

78 East Washington Street

Chicago, Illinois 60602

ELIGIBILITY

The CTA *Arts in Transit Program* is open to all living professional artists regardless of race, color, religion, national origin, gender, age, military status, sexual orientation, marital status, physical or mental disability or residency. Artists working in appropriate materials are encouraged to apply.

SELECTION PROCESS

Artists' submissions will be considered for stations that are appropriate, based on the style, materials, and suitability of the artwork that is documented in the artist's application. A Project Advisory Panel (PAP) will be established to review artist applications and select finalists for each transit station. Each PAP is comprised of the City of Chicago Public Art Program Project Coordinator, community representatives from the neighborhood around each station and

two representatives from the art community. The panel will also include several CTA advisors including a Facilities Planner, a Rail Line General Manager and a Transit Architect.

Each PAP will select two to five artists per transit station to receive a Request for Proposal (RFP) to be issued in April 2006 for Phase I. Artists receiving the RFP will be asked to submit a comprehensive proposal including a maquette in June 2006. Artists who submit a comprehensive proposal will receive a \$500.00 design fee. The proposal becomes the property of the CTA. Each PAP will review proposals and select artists for the commission of permanent artwork for each designated transit station.

PUBLIC SAFETY REQUIREMENTS

Each artwork location has size, weight, structure, material and lighting requirements. All artwork commissioned through the *Arts in Transit Program* must meet all relevant laws, regulations, rules and criteria regarding public safety. Details will be provided to the selected artists as part of the RFP.



Artist: John Hirschfeld

Thank you for your interest
in the CTA Arts in Transit Program.
Your submission has been
received.

(Print your name, address and supply
postage if you wish confirmation
your submission was received.)

Place
Postage
Here

ADDENDUM TO ARTIST SLIDE REGISTRY APPLICATION

CITY OF CHICAGO DEPARTMENT OF CULTURAL AFFAIRS

The undersigned artist ("Artist") understands and acknowledges that the Chicago Public Art Program ("Program") is administered by the Chicago Department of Cultural Affairs; that the Program exists and functions to implement and administer the Percent for Art Program; that the Project Advisory Panels ("PAP's") and the Public Art Committee ("PAC") are bodies through which certain aspects of the Program, including selection of artwork, are effectuated; that the PAP's and PAC are comprised of individual members (collectively referred to as the "Members") whose responsibilities include meeting periodically to discuss the selection of artists for the commission, design, and implementation of artwork; that such meetings are open to the public as a matter of law; that a frank discussion about the Artist's qualifications and his/her artwork is fundamental to the PAP and PAC selection processes; that the Members may express judgments and make related statements in the course of fulfilling their roles with respect to the Program; and that the Artist, by submitting his/her application to the Program's slide registry, is thereby freely and voluntarily acceding to the candid and public evaluation of his/her credentials and work by the Members.

Therefore, the Artist agrees that in no event shall he/she have legal recourse for statements or aesthetic judgments concerning the Artist or his/her work made by the Members, or any of them, in the course of fulfilling their duties on the PAP's or PAC in furtherance of the Program, and further agrees to hold harmless the Members, the City and its agents, officials and employees against all suits, claims, damages, losses and expenses, including attorneys' fees, caused by, growing out of, or incidental to such statements or aesthetic judgments.

AGREED: _____
(Name)

(Date)

REGISTRATION FORM

A. NAME AND ADDRESS

Name of individual artist (last name first): _____

Street address: _____

City: _____ State: _____ Zip Code: _____

Primary Phone: () _____ Secondary Phone: () _____

Website: http:// _____ e-mail: _____

(Chicago Residents Only)

Neighborhood where you live: _____ Ward Number: _____

B. DEALER/GALLERY

To be completed by artist or dealer/agent who serves as a contact for contracts, information, etc.

Name of representative (last name first of individual): *Note: Artist name & address above is required*

Street address: _____

City: _____ State: _____ Zip Code: _____

Telephone: () _____ Fax: () _____

Website: http:// _____ e-mail: _____

C. INSTITUTION/AFFILIATION

Complete only if your employment is related to your discipline specialization.

Name of business, institution or organization: _____

Street address: _____

City: _____ State: _____ Zip Code: _____

Telephone: () _____

D. CATEGORY

Check primary discipline(s)

- ☐ Sculpture
- ☐ Textiles
- ☐ Glassworks
- ☐ Constructions
- ☐ Painting
- ☐ Photography
- ☐ Suspended Work
- ☐ Multimedia
- ☐ Ceramics
- ☐ Reliefs
- ☐ Video
- ☐ Murals
- ☐ Language
- ☐ Mosaics
- ☐ Works on paper
- ☐ Installation

E. MATERIALS

Check as many as appropriate

- ☐ Wood
- ☐ Clay
- ☐ Drawing Mediums
- ☐ Light/Neon
- ☐ Earth
- ☐ Fiberglass
- ☐ Paint
- ☐ Metal
- ☐ Plastic
- ☐ Fiber/Fabric
- ☐ Concrete
- ☐ Glass
- ☐ Computer
- ☐ Sound
- ☐ Stone
- ☐ Other (specify) _____

F. STYLE

Check no more than three

- ☐ Abstract
- ☐ Site-Specific
- ☐ Representational
- ☐ Conceptual
- ☐ Illusionistic
- ☐ Assemblage
- ☐ Expressionistic
- ☐ Political
- ☐ Surrealistic
- ☐ Figurative
- ☐ Narrative
- ☐ Participatory
- ☐ Ornamental
- ☐ Land/cityscape
- ☐ Functional
- ☐ Documentary
- ☐ Ethnic
- ☐ Other (specify) _____

G. PRICE: What is the price range of your work? \$ _____ to \$ _____

H. DATA COLLECTION: *(optional)*

The City of Chicago Public Art Program is committed to working with artists who represent a broad range of cultural backgrounds. We do not discriminate on the basis of race, gender or religion.

Gender:

- ☐ Male
- ☐ Female

Cultural Identity:

- ☐ Native American
- ☐ Asian/Pacific Islander
- ☐ African American
- ☐ Hispanic
- ☐ Caucasian (white, non-hispanic)
- ☐ Other (specify) _____

HOW TO LABEL SLIDES

Directions: Label your slides clearly with name, title, date of execution, and dimensions.

Place a red dot in the lower left-hand corner of the slide mount (when image is oriented for correct viewing). Use permanent stick labels to avoid peeling, lost slides and jammed projectors.

ARTIST NAME
TITLE OF WORK, DATE

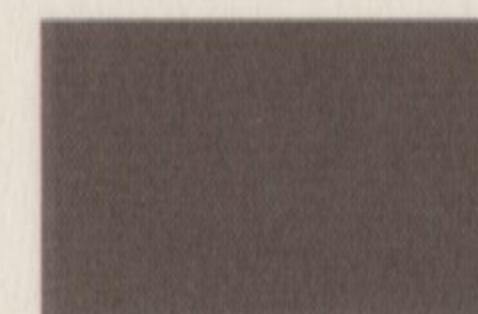

MEDIUM PRICE
DIMENSIONS
LOCATION

ARTIST:

LAST NAME, FIRST NAME

CTA ARTS IN TRANSIT PROGRAM PUBLIC ART PROGRAM

CITY OF CHICAGO

78 East Washington Street
Chicago, Illinois 60602

